

HYUNG JAE PRECISION MACHINERY

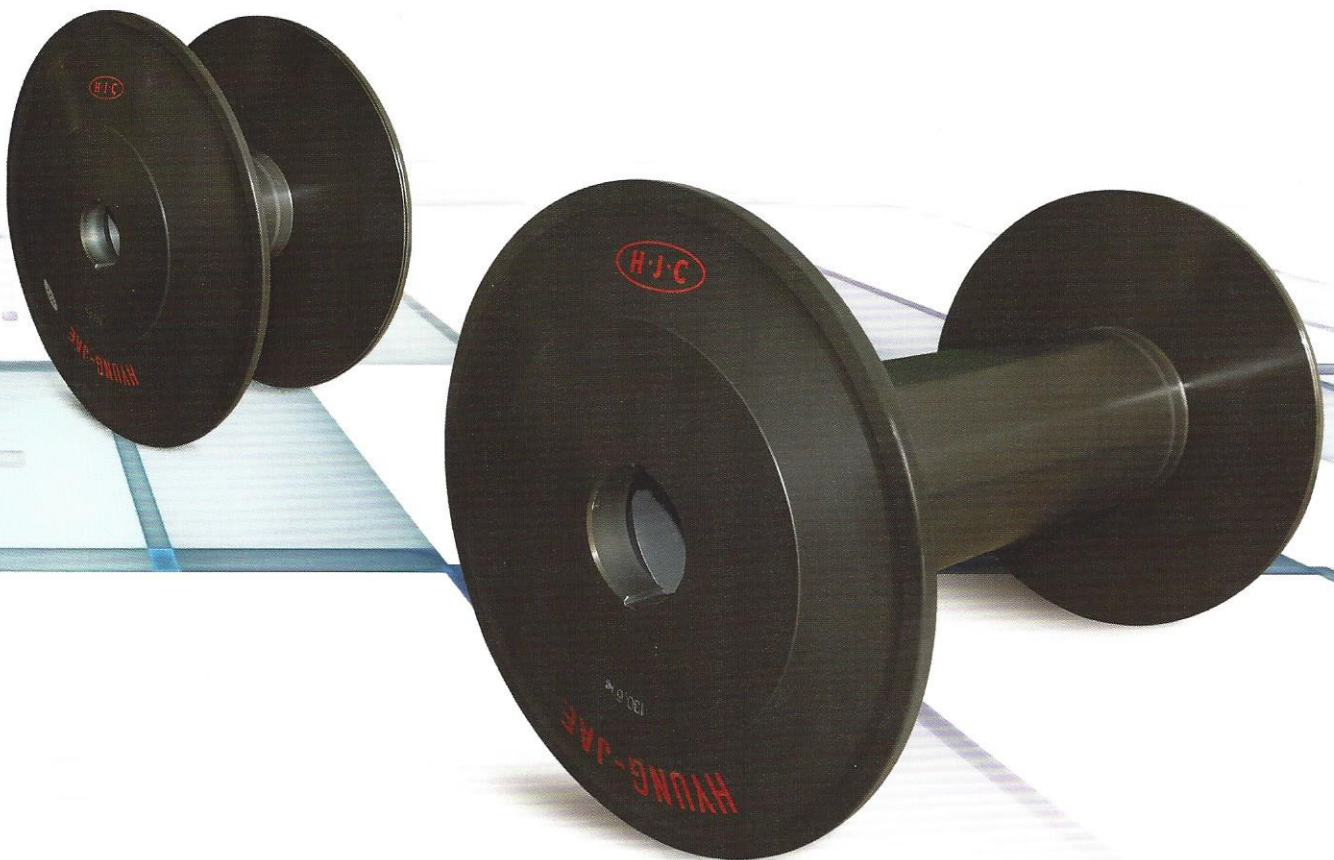

HYUNG JAE PRECISION MACHINERY CO., LTD.
www.hyungjae.co.kr / E-mail : hyungjae@hyungjae.co.kr

HYUNG JAE

PRECISION MACHINERY CO., LTD.



We Are Doing Our Best To Meet Your Every
Requirement And Assure Your Full Satisfaction With
Excellent Quality, On-time Delivery And Competitive Prices.

With Accumulated **Technology** And **Advanced Facilities**

We are Committed To Make On Tiny Item Perfect

GREETINGS

Spirit of mother who tailored clothes for her younger son with devoted stitch-by stitch sewing regarding even single thread precisely, was endowed to our products.

We exert ourselves to become an enterprise which make excellent and yet more cost effective products on the basis of sincerity, honesty, reliance, ceaseless efforts and R&D activities, and which answer heartily to the tiny asks from consumers.

We are grateful to all of our customers for their encouragement and cooperation.

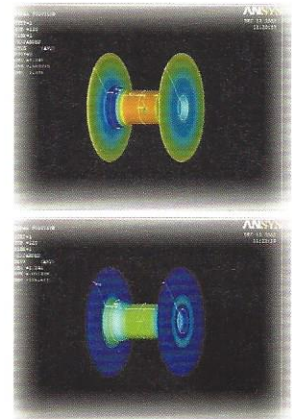

GUARANTEED WARPING YARN LENGTH

DESCRIPTION	21" x 21" x 30T 580ENDS		30" x 21" x 30T 580ENDS		30" x 42" x 44.5T 1174ENDS		40" x 42" x 67.5T 1174ENDS		
	LENGTH(m)	WEIGHT(kg)	LENGTH(m)	WEIGHT(kg)	LENGTH(m)	WEIGHT(kg)	LENGTH(m)	WEIGHT(kg)	
N / F	20d	54,800	71	79,000	103	87,000	227	134,500	350
	40d	29,400	76	50,500	130	55,000	287	85,000	443
	50d	22,700	73	43,500	140	47,200	308	73,000	476
	70d	15,500	70	30,600	138	33,400	305	51,700	472
P / F	30d	47,500	92	81,800	158	89,000	348	138,000	540
	50d	25,900	84	52,000	168	57,000	371	88,400	576
	75d	16,400	79	32,600	158	35,700	349	55,400	542
	75d	40" x 21" x 50T(580ENDS) : 265kg				40" x 42" x 50T(1160ENDS) : 550kg			
SPANDEX LYCRA	40d	21" x 21" x 40T(680ENDS) : 58kg				30" x 42" x 45T(1380ENDS) : 193kg			

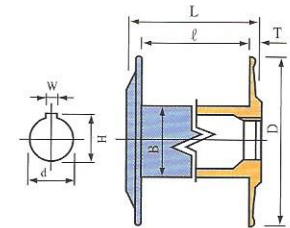
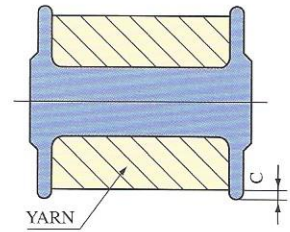

• C must be over 15mm for all beams.

SPECIFICATIONS

MEASUREMENT	SIZE(INCH)	DIMENSION								WEIGHT Kg	AVAILABLE YARN								
		D x L		mm T inch	mm D inch	mm Ø inch	mm L inch	mm B inch	mm d inch			mm H inch	mm W inch						
HEAVY DUTY STANDARD For mono & multifilament Nylon, Polyester Spandex, Lycra yarns etc.	21 x 21	30	1.18	532	20.94	470	18.50	530	20.87	210	8.27	152.7	6.01	159.5	6.28	19.6	0.77	36	Nylon, Polyester
	21 x 21	40	1.57	532	20.94	450	17.72	530	20.87	210	8.27	152.7	6.01	159.5	6.28	19.6	0.77	43	Spandex, Lycra
	21 x 42	40	1.57	532	20.94	986	38.82	1066	41.97	210	8.27	152.7	6.01	159.5	6.28	19.6	0.77	62	Spandex, Lycra
	21 x 21 Big Barrel	40	1.57	532	20.94	450	17.72	530	20.87	300	11.81	152.7	6.01	159.5	6.28	19.6	0.77	55	Spandex, Lycra
	21 x 42 Big Barrel	40	1.57	532	20.94	986	38.82	1066	41.97	300	11.81	152.7	6.01	159.5	6.28	19.6	0.77	75	Spandex, Lycra
	30 x 21	30	1.18	762	30.00	470	18.50	530	20.87	300	11.81	152.7	6.01	159.5	6.28	19.6	0.77	85	Nylon, Polyester
	30 x 21	40	1.57	762	30.00	450	17.72	530	20.87	300	11.81	152.7	6.01	159.5	6.28	19.6	0.77	97	Spandex, Lycra
	30 x 42	44.5	1.75	762	30.00	977	38.46	1066	41.97	300	11.81	152.7	6.01	159.5	6.28	19.6	0.77	131	N&P / Spandex, Lycra
	40 x 21	50	1.97	1000	39.37	430	16.93	530	20.87	300	11.81	152.7	6.01	159.5	6.28	19.6	0.77	160	Nylon, Polyester
	40 x 42	50	1.97	1000	39.37	968	38.11	1068	42.05	300	11.81	152.7	6.01	159.5	6.28	19.6	0.77	188	Polyester
	40 x 42	60	2.36	1000	39.37	948	37.32	1068	42.05	300	11.81	152.7	6.01	159.5	6.28	19.6	0.77	215	Nylon, Polyester
	42 x 21	50	1.97	1060	41.73	430	16.93	530	20.87	300	11.81	152.7	6.01	159.5	6.28	19.6	0.77	175	Nylon, Polyester
42 x 42	60	2.36	1060	41.73	948	37.32	1068	42.05	300	11.81	152.7	6.01	159.5	6.28	19.6	0.77	234	Nylon, Polyester	
Heavy duty Diabolo	40 x 42	67.75	2.67	1000	39.37	933	36.73	1068	42.05	300	11.81	152.7	6.01	159.5	6.28	19.6	0.77	223	Nylon, Polyester

• Beams of other specifications can be made on request.

• For the beams of 40" DIA, the use of Lever Typed Chucking Adaptor [Not Ball Type] is recommended, while yarn warping, due to heavy weight.

DRAW WARPERS BEAM FOR RASCHEL & TRICOT

SPECIAL FEATURE

- Flange : Made of high strength aluminium alloy and manufactured by high pressure forging press, so it has excellent rigidity and durability.
- Barrel : As an extruded pipe of heat-treated aluminium alloy, it has high strength and precision.
- Welding : Welded with high precision MIG automatic welding method by ROBOT system.
- Because of dynamic balancing function, a good compatibility with knitting machine is maintained even though high-speed rotation.
- Through hard anodizing coating treatment, corrosion and surface scratching are entirely prevented.
- Durability and precision are maintained even after several years utility.



40" x 42" x 50T



40" x 21" x 50T



30" x 42" x 44.5T



21" x 42" x 40T BIG BARREL



30" x 21" x 30T



21" x 42" x 40T



21" x 21" x 30T

BEST EXPERT HYUNG JAE FOR YOUR SAFETY



THE PRODUCTION FACILITIES



NC working



Welding process

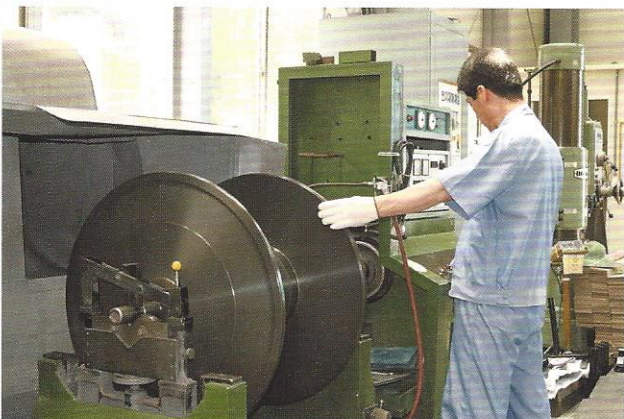



Balancing process



Production facilities

You Will Be Surprised By Its Preciseness

At First Use And Impressed By Its Durability In Years

CERTIFICATE		
of Conformity EC Council Directive 99/37/EC Machinery		
Registration No.:	AM 9855371 01	
Report No.:	M 9866508 E 01	
Holder:	Hyung Jae Precision Mach. Co., Ltd. 359-8 Galsan Dong, Dalseo Gu Taegu Shi 704-170 R.O.K.	
Product:	TEXTILMASCHINE (Sectional Beam for Raschel & Tricot)	
Identification:	Type Designations : 430*x44.5T, 430*x30T Serial Number : n.a.(prototype)	
Remarks:	Sectional beam ISO 8116-5 - 762x978 (430*x44.5T) Sectional beam ISO 8116-5 - 762x470 (430*x30T)	
<small>This certificate of conformity is based on an evaluation of a sample of the above mentioned product. This is to certify that the tested sample is in conformity with all provisions of Annex I of Council Directive 99/37/EC, referred to as the Machinery Directive. This certificate does not imply assess- ment of the production of the product and does not permit the use of a TÜV Rheinland mark of con- formity. The holder of the certificate is authorized to use this certificate in connection with the EC declaration of conformity according to Annex II of the Directive.</small>		
		Certification Body
		 
Cologne,	02.11.98	
TÜV Rheinland Product Safety GmbH - Am Grauen Stein - D-51105 Köln		
© The CE marking may be used if all relevant and effective EC Directives are complied with. ©		



INNOBIZ
기술혁신형중소기업



Registered
ISO 9001:2008 / ISO 14001:2004



HYUNG JAE PRECISION MACHINERY CO., LTD.

25, DALSEO-DAERO 94-GIL, DALSEO-GU, DAEGU

TEL : 82-53-582-7744~5, 1770-3 / FAX : 82-53-582-8134 / E-mail : hyungjae@hyungjae.co.kr / www.hyungjae.co.kr